



# Ambiance control at your fingertips

KNX Home Automation

[schneider-electric.com](https://schneider-electric.com)

Life Is On

**Schneider**  
Electric

# Schneider Electric presents its residential control and energy management solution...



KNX Home Automation is a complete solution for home automation which also provides the relevant energy awareness required by the new building regulations.

The control functions improve comfort, security and flexibility for the occupant and owners. The system is complete, open and scalable. It brings a real differentiation factor and added value to your program and speeds up sales. Schneider Electric offers a tailor made solution, that is easy to implement and duplicate.

“ With the KNX Home Automation solution, Schneider Electric offered an innovative modular solution. The people who buy my apartments are very interested by the proposition of control and energy dashboard. I intend to carry on working with this system on my future programs.

Mr Miller,  
promoter

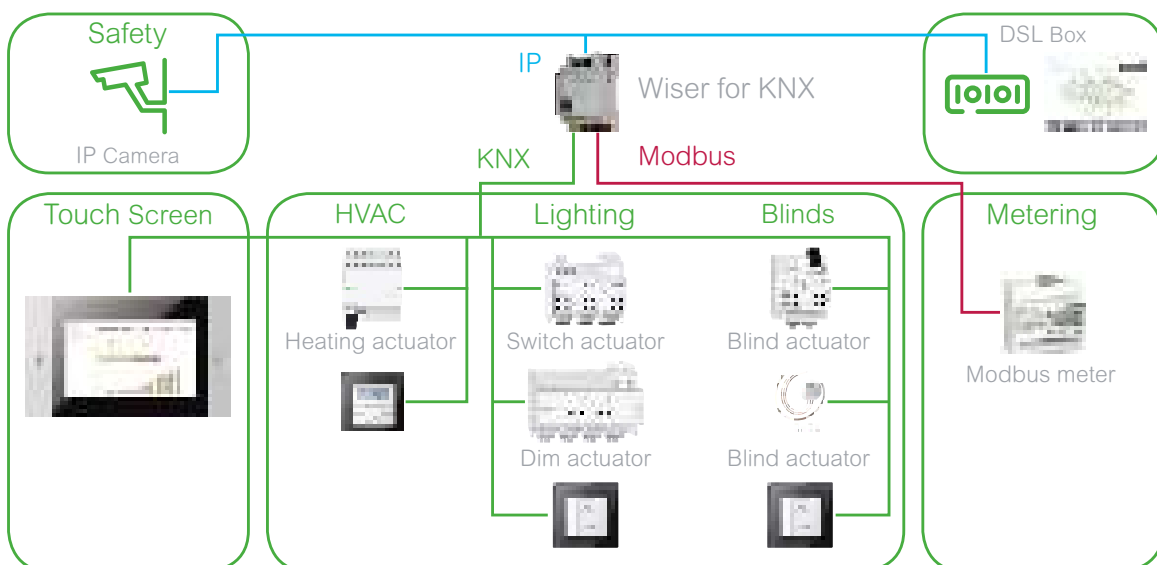

# ...and support by your usual partners for site realisation.



Schneider Electric has a network of installation partners trained and experimented in delivering our KNX Home Automation solution. Tools to help specify, install and commission the system enable perfect site coordination. Schneider Electric prides themselves in providing the best possible training and information through our trusted network of partners. By supporting your project through the entire process, you can rest easy knowing your project will run smoothly.

“ To simplify the installation of the KNX Home Automation solution, we have worked with Schneider Electric and their partners in order to simplify the site management. It's enabling us to respect planning and offer a project answering our customer's expectations.

Mr Scott,  
main contractor



Solutions are tested and validated according to Schneider Electric process

## Tested and validated solution



### Proven solutions

Before putting these solutions to the market Schneider Electric has put them to the test making sure all the integration work is smooth and delivers the expected results.



### Integration Manual

The project will be specified using recommended control architectures which use tried and tested components, software and integration methodology.



### The backing of Schneider Electric

Schneider Electric partner programs guarantees that you will have the best trained professional to support your project and technical backing of a leading manufacturer.

# A maximum of comfort in the home...

## Comfort management



KNX Home Automation combines the technologies for blinds, lighting and heating to fit occupant needs. The “away” mode enables the occupant to save energy and therefore, money when away. The “ECO” mode can be used to reduce the temp set point to reduce energy costs.

## Lighting and Blind control

KNX Home Automation enables the occupant to control blinds and lights individually. You can even control by zone, time of day or central command.



## Heating Control



KNX Home Automation provides temperature control by room, zone and centralised, giving the occupant the right level of comfort when needed.

Combined with a yearly time of day schedule, it creates substantial energy savings. When unpredictable drops in temperature happen, the frost protection mode protects the home from damage.

# ...with a high level of security, energy efficiency and flexibility



## Scheduler/Calendar

Integrated time scheduler/calendar function built-in the KNX Home Automation enables the occupant with the capability to plan the occupation, the temperature according to the mood or activity taking place (work, relax, weekend). When the home is unoccupied there is also the possibility to simulate occupied mode providing a first level of security.



## Energy consumption follow-up



KNX Home Automation delivers a real time display of the water, gas and electricity consumption, as well as providing historical data on a daily, monthly and yearly basis. It is even possible to export the data for further analysis and design your own statistical measurements.



## Safety

IP cameras can also be connected into the KNX Home Automation visualisation platform enabling the possibility to visualise the image on the home tablet or on a smartphone remotely.



# Residential Solution with Schneider Electric



Schneider Electric offers products and solutions for residential buildings

## Home Control Network

KNX architecture

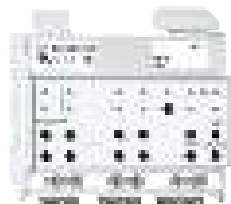

## Computer Network

IP architecture

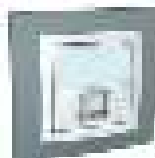

## Electrical distribution

Opale cabinet



## Energy metering

Energy meters complete range

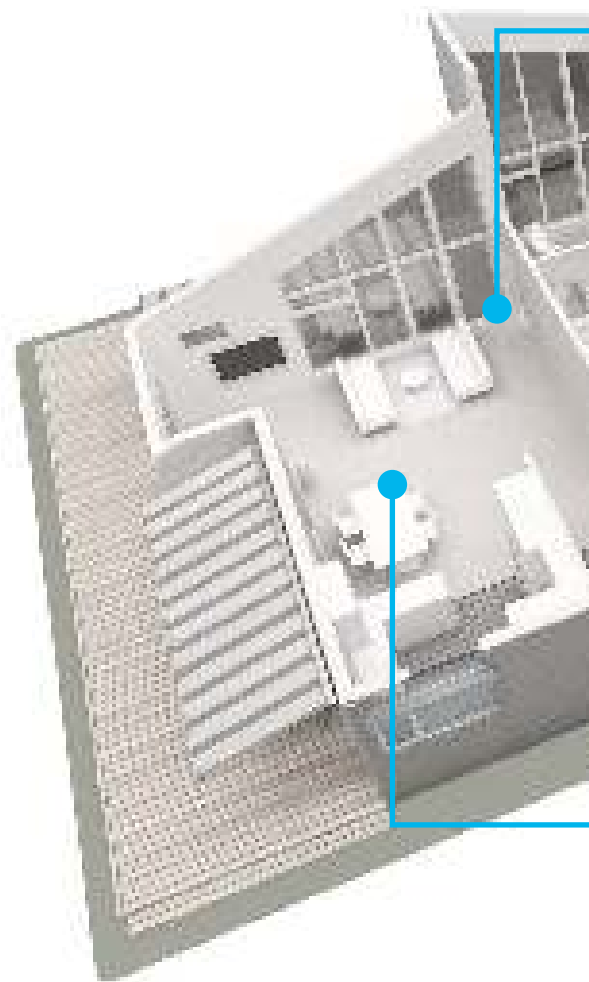

## Wiser for KNX webserver

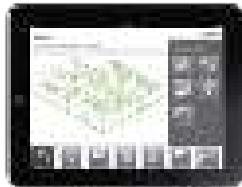
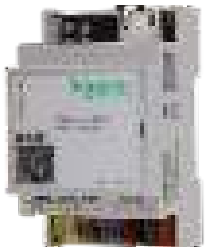

A perfect integration in your home with Wiser for KNX Logic Controller (IP, KNX, Modbus... and integrated in cabin

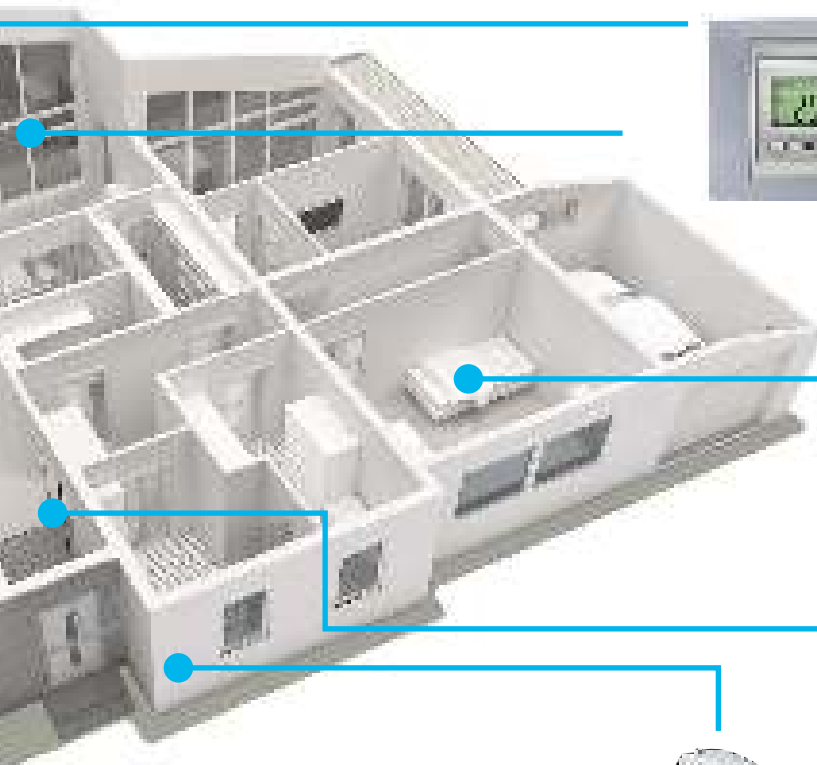

A complete range of push buttons, detectors, and room control unit to control the home, with an attractive and general design (sockets, computer sockets, ie)



Touch screens (7, 10 inches)

Design cabinet



Automatic management of lights, shutters and heating, depending on weather informations (wind, luminosity, temperature, CO2, humidity)



Interface with security products: DAAF, alarms, ie

Life Is On

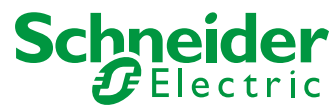

[schneider-electric.com](http://schneider-electric.com)

Schneider Electric Industries SAS  
35, rue Joseph Monier - CS 30323  
F92500 Rueil-Malmaison Cedex